

# Service Crimpers

Compact, universal and powerful.



# Content



Page 08-09  
SL 3



Page 10-11  
SH 2 (S2)



Page 12-13  
HM 200



Page 14-15  
SC 3 | SC 4  
(S 3 | S 4)



Page 16-17  
SH 4  
(S 3L Ecoline)



Page 18-19  
SH 7 (S 7)



Page 20-21  
SC 6 | SC 6 S  
(S 6 | S 6 S)



Page 22-23  
SH 6  
(S 6 L)



Page 24-25  
SH 10 | SH 10 XL  
(S 10 Ecoline | S 10 XL)



Page 26-27  
SC 12 i



Page 28  
Packages and  
Accessories



# Service Crimpers



## Greaseless

- Slide bearings on the crimp tool improve efficiency up to 20%, reduce friction and help keep the tool free of contaminants
- No greasing improves cleanliness of machine
- Prolongs the machine's lifetime
- Maximum productivity with very low maintenance costs
- No risk of prematurely damaging the crimping head
- End product can be used in sanitary applications without cleaning
- 20% more capability for crimping stronger or more difficult couplings versus our competition's equivalent crimpers
- Consistently accurate crimp result



## Universal

- For all types of hoses and fittings



## Ecoline

- Value driven solution for less frequent use



## Ergonomic

- Free access for fast loading of the tool
- Compact design fits in any workshop and is ideal for on-site service
- Large opening travel for easy crimping of elbow fittings without removing the dies



## Environment friendly

- Energy efficient and durable

# UNIFLEX changes the names of some products for a better understanding.

(The old product names can be found in brackets after the new product names)

## SC = Press tool with Cylinder

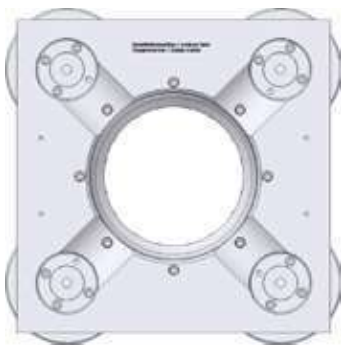

Front view

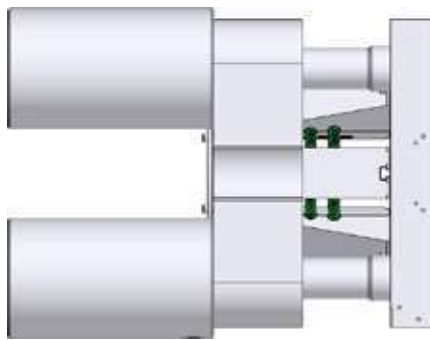

Side view

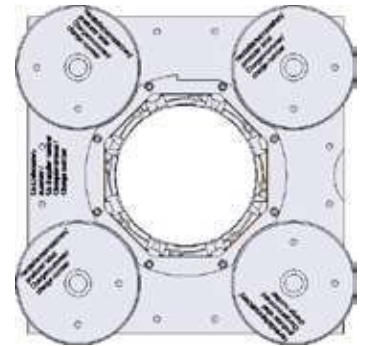

Rear view

## SH = Hollow piston press tool

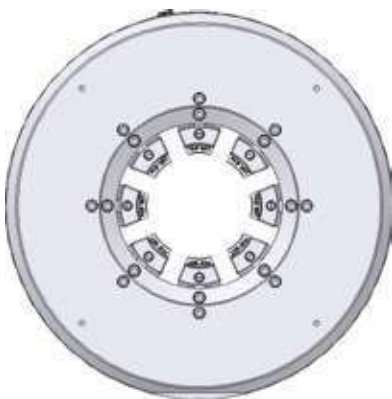

Front view

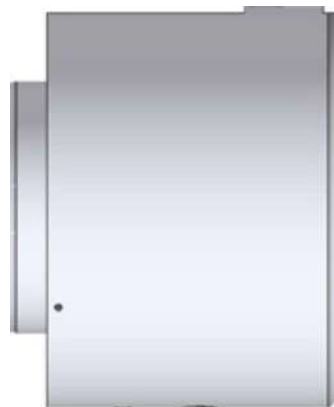

Side view



Rear view

	SC	SH
No greasing	★ ★ ★	★ ★ ★
Low maintenance	★ ★ ★	★ ★
Compact	★ ★	★ ★ ★
Light weight	★ ★	★ ★ ★
Accessibility of the workpiece	★ ★ ★	★ ★
Dirt-sensitivity	★ ★ ★	★
Sustainable	★ ★ ★	★ ★
Good value	★ ★	★ ★ ★
Well suited for	Workshop	Mobile
Factory warranty in years	3	2



Next-generation crimper for low pressure hose assemblies. Two-in-one solution with integrated die sets O5 and O15 for DN 03-16. With the SL 3-16 M, UNIFLEX innovates the existing crimper: Two integrated die sets in one tool. No more lost time changing the die. Just change the handle and you are already crimping the other size. No risk of losing dies, no dirty hands, no "time lost". With the built-in handle, you can easily carry it anywhere.

SL 3-32 M and SL 3-75 complete the range with large opening travel up to 3".



SL 3-16 M



SL 3-32 M



SL 3-75\_A (PUU not included)





SL 3-16 M

SL 3-32 M

SL 3-75

Technical Data	SL 3-16 M	SL 3-32 M	SL 3-75
Crimp force (kN/Ton)	30/3	200/20	500/50
Opening travel (mm/inch)	+31.7/+1.24	+36.7/+1.44	+55/+2.16
Industrial	5/8"	1 1/4" **	3"
Opening without dies (mm/inch)	38.6 / 1.52	88 / 3.46	115 / 5.52
Type of dies	150	263	239
Master dies length (mm/inch)	10/0.39	68/2.68	75/2.95
L x W x H (mm)	340 x 143 x 780	216 x 165 x 348	420 x 520 x 550
Weight	20 kg	28 kg	88 kg

Type of dies		Type of dies	
	<b>263</b>		<b>239</b>
Ø mm	mm	Ø mm	mm
6.8	40	6.8	50
9	75	9	50
12	75	10	50
14	75	12	50
17	75	14	60
20	75	16	60
24	75	17	60
28	75	19	60
32	75	20	60
36	75	22	60
40	75	24	60
44	75	26	75
47	75	28	75
		30	75
		31	75
		32	75
		34	75
		36	75
		38	75
		39	75
		40	75
		44	75
		47	75
		50	75
		54	75
		57	75
		62	75

\*\* With master dies.

Dies 150: 6.9 mm and 14.9 mm.

## Description



2 sets of dies integrated,  
no dies set change!  
(Only for SL3-16M)



Must workshops and mobile service teams do without the power and reliability of large stationary crimpers? UNIFLEX's answer is a definite "no". Our compact, multi-purpose workshop crimpers prove that the advantages of the legendary slide bearing technology can also be used in light-weight, inexpensive equipment that will fit into almost any vehicle and workshop.

The SH 2 series models offer an optimal force-to-weight ratio of 1" 4 SP at a weight of 29 kg, a large opening stroke up to 22 mm (0.87") and a maximum pressing range up to 63 mm (2.48").



SH 2 MH 2



SH 2 P



SH 2 A



SH 2 M H2	SH 2 M Ecoline	SH 2 P	SH 2 A	SH 2 LA
-----------	----------------	--------	--------	---------

Technical Data	SH 2 M H2	SH 2 M Ecoline	SH 2 P	SH 2 A	SH 2 LA	Type of dies																												
Crimp force (kN/Ton)	900/90	900/90	770/77	900/90	450/45	 <b>263</b> <table border="1"> <thead> <tr> <th>Ø mm</th> <th>mm</th> </tr> </thead> <tbody> <tr><td>6.8</td><td>40</td></tr> <tr><td>9</td><td>75</td></tr> <tr><td>12</td><td>75</td></tr> <tr><td>14</td><td>75</td></tr> <tr><td>17</td><td>75</td></tr> <tr><td>20</td><td>75</td></tr> <tr><td>24</td><td>75</td></tr> <tr><td>28</td><td>75</td></tr> <tr><td>32</td><td>75</td></tr> <tr><td>36</td><td>75</td></tr> <tr><td>40</td><td>75</td></tr> <tr><td>44</td><td>75</td></tr> <tr><td>47</td><td>75</td></tr> </tbody> </table>	Ø mm	mm	6.8	40	9	75	12	75	14	75	17	75	20	75	24	75	28	75	32	75	36	75	40	75	44	75	47	75
Ø mm	mm																																	
6.8	40																																	
9	75																																	
12	75																																	
14	75																																	
17	75																																	
20	75																																	
24	75																																	
28	75																																	
32	75																																	
36	75																																	
40	75																																	
44	75																																	
47	75																																	
No grease: 20% less friction	✓	✓	✓	✓	✓																													
SAE R 12/4SP* 1 piece fitting	1 1/4"	1 1/4"	1 1/4"	1 1/4"	3/4"																													
SAE R 15/4SH* 2 piece fitting	1"	1"	1"	1"	5/8"																													
Industrial	1 1/4"	1 1/4"	1 1/4"	1 1/4"	1 1/4"																													
90° Elbows	1"	1"	1"	1"	1"																													
Max. Crimp range** (mm/inch)	63 / 2.48	63 / 2.48	63 / 2.48	63 / 2.48	63 / 2.48																													
Opening (mm/inch)	+22 / +19.06	+22 / +19.06	+22 / +19.06	+22 / +19.06	+22 / +19.06																													
Opening without dies (mm/inch)	77 / 3.03	77 / 3.03	77 / 3.03	77 / 3.03	77 / 3.03																													
Master dies length (mm/inch)	75 / 2.95	75 / 2.95	75 / 2.95	75 / 2.95	75 / 2.95																													
Type of dies	263	263	263	263	263																													
Speed (mm/sec)																																		
Close	-	-	0.9	5.8	2.4																													
Crimp	-	-	0.9	0.6	0.2																													
Drive	Manual	Manual	Pneumatic ***	1 VAC	1 VAC																													
Oil	0.75 l	0.75 l	2 l	1.5 l	1.5 l																													
L x W x H (mm)	500 x 420 x 440	216 x 165 x 348	380 x 400 x 310	450 x 450 x 350	450 x 450 x 450																													
Weight	32 kg	29 kg	33 kg	41 kg	56 kg																													

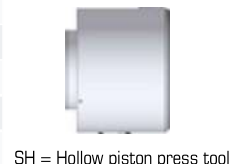

\* According to the fitting. \*\* With master dies. \*\*\* 7 bar/98 psi.  
 Packages page 28 / Accessories and options page 56

## Description

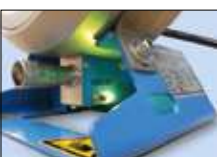

On SH 2 models, an optical signal is given when the crimp measure is reached. The electric and pneumatic variants have an automatic stop function.



Telescopic hand-lever available. Included with SH 2 M machines.



New standard by SH 2 MH and SH 2 M Ecoline with special pump. (The low pressure delivery volume is around three times higher than the standard.) 32/3 cc instead of 11/3 cc



PUM 0.8/3.2-700 bar. The mobile high pressure unit achieves 700 bar: a real magic box!



SH 2 DC



As the unrivaled classic in the 1" field, with its narrow, innovative construction, high level of user friendliness, versatility and long service life, the HM 200 sets the unbeatable standard for quality and cost effectiveness. Its compact construction allows for ergonomic working. The use of different die sets allows pressing of all types of fittings, and the proven greaseless slide bearing technology reduces maintenance costs. The Ecoline model is hydraulically controlled and has a separate tank to save space in workshops.



HM 200



HM 200 Ecoline





PUU (optional)



HM 200

HM 200 Ecoline

Technical Data	HM 200	HM 200 Ecoline
Crimp force (kN/Ton)	1,300/130	1,300/130
No grease: 20% less friction	✓	✓
Control	Control A	Control A
SAE R 12/4SP* 1 piece fitting	1½"	1½"
SAE R 15/4SH* 2 piece fitting	1"	1"
SAE R 12/4SP* 2 piece fitting	1¼"	1¼"
Industrial	2"	2"
90° Elbows	1½"	1½"
Max. Crimp range (mm/inch)	70 / 2.76	70 / 2.76
Opening (mm/inch)	+30 / +1.18	+30 / +1.18
Opening without dies (mm/inch)	100 / 3.94	100 / 3.94
Master dies length (mm/inch)	75 / 2.95	75 / 2.95
Type of dies	239	239
Speed (mm/sec)		
Close	3.5	3.5
Crimp	3.5	3.5
Open	5.9	5.9
Noise level	69 dBA	69 dBA
Drive	3 kW 3 VAC	3 kW 3 VAC
Oil	40 l	40 l (DC 4 l)
L x W x H (mm)	800 x 530 x 630	420 x 535 x 520
Power Unit L x W x H (mm)	-	300 x 450 x 560
Weight	140 kg	92 kg (without power unit), 130 kg (with die package)
<b>Options</b>		
12 VDC/24 VDC	-	✓
1 VAC	✓	2.2 kW
Control C.2/IPC	✓	-

Type of dies	
	
<b>239</b>	
Ø mm	mm
6.8	50
9	50
10	50
12	50
14	60
16	60
17	60
19	60
20	60
22	60
24	60
26	75
28	75
30	75
31	75
32	75
34	75
36	75
38	75
39	75
40	75
44	75
47	75
50	75
54	75
57	75
62	75



SC = Press tool with Cylinder

\* According to the fitting.  
Packages page 28 / Accessories and options page 56

## Description



The micrometer allows you to easily set the crimping diameter.



The large opening stroke allows you to pass 90° fittings without changing the crimp dies.



The 12 VDC/24 VDC units offer space- and weight-saving application options, e.g. for fitting service trucks.  
L x W x H (mm)  
441 x 291 x 296; 21 kg



A box with master dies is available in a package.



For mobile applications the HM 200 is also ideally suitable.



Due to their narrow and innovative construction, high level of user friendliness and long service life, the SC 3 and SC 4 set new standards for quality and cost effectiveness. Their compact construction allows for ergonomic working. The use of long master dies allows you to crimp 90° elbow fittings up to 1 ¼" for SC 3 and 1 ½" for SC 4, with the tried and tested greaseless slide bearing technology, which reduces maintenance costs and increases the product quality.

Because the 4-cylinder technology keeps press waste away from the die, UNIFLEX offers a 3-year warranty for the SC 3 and SC 4 series.



SC 3 Ecoline



SC 4 Ecoline



SC 4 C.2



SC 3 Ecoline

SC 4 Ecoline

SC 4 C.2

Technical Data	SC 3 Ecoline	SC 4 Ecoline	SC 4 C.2
Crimp force (kN/Ton)	1,200/120	1,800/180	1,800/180
No grease: 20% less friction	✓	✓	✓
Control	Control A	Control A	Control C.2 + Touch
SAE R 12/4SP* 1 piece fitting	1½"	2"	2"
SAE R 15/4SH* 2 piece fitting	1"	1¼"	1¼"
SAE R 12/4SP* 2 piece fitting	1¼"	2"	2"
Industrial	2"	2"	2"
90° Elbows	1½"	1½"	1½"
Max. Crimp range (mm/inch)	70 / 2.76	70 / 2.76	70 / 2.76
Opening (mm/inch)	+35 / +1.38	+35 / +1.38	+35 / +1.38
Opening without dies (mm/inch)	105 / 4.13	105 / 4.13	105 / 4.13
Master dies length (mm/inch)	100 / 3.94	100 / 3.94	100 / 3.94
Type of dies	239-xx-Ø	239 - xx	239 - xx
Speed (mm/sec)			
Close	4.0	2.7	2.7
Crimp	4.0	2.7	2.7
Open	6.5	4.7	4.7
Noise level	69 dBA	69 dBA	69 dBA
Drive	3 kW 3 VAC	3 kW 3 VAC	3 kW 3 VAC
Oil	35 l	35 l	35 l
L x W x H (mm)	592 x 545 x 672	592 x 545 x 672	720 x 600 x 672
Weight	150 kg	160 kg	203 kg
<b>Options</b>			
12 VDC/24 VDC	✓	✓	-
1 VAC	✓	✓	✓
Control C.2/IPC	✓	-	✓

Type of dies	
Ø mm	mm
6.8	65
9	65
10	65
12	65
14	65
16	65
17	65
19	65
20	65
22	65
24	65
26	65
28	80
30	80
31	80
32	80
34	80
36	80
38	80
39	80
40	80
44	80
47	100
50	100
54	100
57	100
62	100

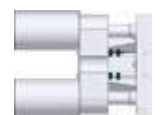

SC = Press tool with Cylinder

\* According to the fitting.  
Packages page 28 / Accessories and options page 56

## Description



The SC 3- and SC 4-series is fitted with the clean slide bearing technology.



The SC 3- and SC 4-series can be used to crimp short 90° elbow fittings with a long drop. This is impossible for other conventional machines.



With the double pin connection, it is possible to crimp on the front and rear sides.



The 12 VDC/24 VDC units offer space- and weight-saving application options, e.g. for fitting service trucks.  
L x W x H (mm)  
441 x 291 x 296; 21 kg



PB 239-MD-Ø 70  
Closing Pin for Master dies SC 4  
(Ø 70 mm)



Due to its narrow and innovative construction, high level of user friendliness and long service life, the SH 4 sets new standards for quality and cost effectiveness. Its very compact design despite a high pressing force and a weight of only 110 kg allows ergonomic operation even on mobile jobs. The long base jaws enable pressing up to 1½" 4 SP, the proven greaseless slide bearing technology reduces maintenance costs and increases production quality.



SH 4 Mobileline



SH 4 Ecoline

SH 4 Mobileline

Technical Data	SH 4 Ecoline	SH 4 Mobileline
Crimp force (kN/Ton)	1,800/180	1,800/180
No grease: 20% less friction	✓	✓
Control	Control A	Control A
SAE R 12/4SP* 1 piece fitting	2"	2"
SAE R 15/4SH* 2 piece fitting	1¼"	1¼"
SAE R 12/4SP* 2 piece fitting	2"	2"
Industrial	2"	2"
90° Elbows	1¼"	1¼"
Max. Crimp range (mm/inch)	70 / 2.76	70 / 2.76
Opening (mm/inch)	+27 / +1.06	+27 / +1.06
Opening without dies (mm/inch)	97 / 3.82	97 / 3.82
Master dies length (mm/inch)	110 / 4.33	110 / 4.33
Type of dies	239-xx-Ø	239-xx-Ø
Speed (mm/sec)		
Close	2.0	0.7
Crimp	2.0	0.7
Open	7.6	3.0
Noise level	69 dBA	69 dBA
Drive	3 kW 3 VAC	1,8 kW 1 VAC
Oil	35 l	4 l
L x W x H (mm)	600 x 550 x 630	430 x 370 x 440
Weight	150 kg	110 kg (without power unit)
<b>Options</b>		
12 VDC/24 VDC	-	✓
1 VAC	✓	✓
Control C.2/IPC	✓	-

Type of dies



**239-xx-Ø-yy**

Ø mm	mm
6.8	65
9	65
10	65
12	65
14	65
16	65
17	65
19	65
20	65
22	65
24	65
26	65
28	80
30	80
31	80
32	80
34	80
36	80
38	80
39	80
40	80
44	80
47	100
50	100
54	100
57	100
62	100



SH = Hollow piston press tool

\* According to the fitting.  
 Packages page 28 / Accessories and options page 56

Description



The 12 VDC/24 VDC units offer space- and weight-saving application options, e.g. for fitting service trucks.  
 L x W x H (mm)  
 441 x 291 x 296; 21 kg



PB 239-MD-Ø 70  
 Closing Pin for Master dies SH 4.  
 (Ø 70 mm)



For mobile applications the SH 4 Mobileline is also ideally suitable.



Due to its narrow, innovative construction, high level of user friendliness, and long service life, the SH 7 sets the standard for quality and cost effectiveness. Balanced weight (2" / 77 kg) and compact engineered design make the SH 7 perfect for workshops and on-site service as well as a service or reserve press for quick use. The proven greaseless slide bearing technology with quick-change system reduces maintenance costs, extends service life and increases accuracy.



SH 7



Quick insertion of the jaws



SH 7 with closed dies and QDC



SH 7

SH 7 S



Technical Data	SH 7	SH 7 S
Crimp force (kN/Ton)	2,400/240	3,200/320
No grease: 20% less friction	✓	✓
Control	Control A	Control A
SAE R 15*/4SH 1 piece fitting	2"	2"
4SH* 2 piece fitting	2"	2"
SAE R 15* 2 piece fitting	1½"	1½"
Industrial	2"	2"
90° Elbows	1½"	1½"
Max. Crimp range (mm/inch)	82 / 3.23	82 / 3.23
Opening (mm/inch)	+24 / +0.94	+24 / +0.94
Opening without dies (mm/inch)	110 / 4.33	110 / 4.33
Master dies length (mm/inch)	90 / 3.54	90 / 3.54
Type of dies	239 - xx/265	239 - xx/265
Speed (mm/sec)		
Close	Manuell	Manuell
Crimp	0.42	0.42
Open	Manuell	Manuell
Noise level	70 dBA	70 dBA
Drive	0.75 kW 3 VAC	0.75 kW 3 VAC
Oil	2.3 l	2.3 l
L x W x H (mm)	430 x 367 x 682	430 x 367 x 682
Options	77 kg	77 kg
<b>Options</b>		
12 VDC/24 VDC	✓	✓
1 Phase	✓	✓
Control IPC	-	-

Type of dies	
	<b>239-xx-Ø-yy</b>
Ø mm	mm
6.8	65
9	65
10	65
12	65
14	65
16	65
17	65
19	65
20	65
22	65
24	65
26	65
28	80
30	80
31	80
32	80
34	80
36	80
38	80
39	80
40	80
44	80
47	100
50	100
54	100
57	100
62	100

Type of dies	
	<b>265</b>
Ø mm	mm
54	100
57	100
62	100
67	100
71	100
74	100



SH = Hollow piston press tool

\* According to the fitting.  
Packages page 28 / Accessories and options page 56

## Description



The micrometer allows you to easily set the crimping dimensions.



The machine is pre-positioned manually.



The lightest mobile 2"-service crimping machine. Also available in 12 VDC/24 VDC.



265.2 Turntable



With its slim, innovative design, high user-friendliness, versatility and long service life, the SC 6 series with its 4-cylinder technology sets standards for quality and economy. Its very compact design, despite the large opening travel, allows ergonomic working. The long base jaws enable the SC 6 to crimp short 90° fittings up to 2" 4 SP, and the SC 6 S up to 2" R 15. The proven greaseless slide bearing technology reduces maintenance costs, extends service life and increases accuracy. Because the 4-cylinder technology keeps press waste away from the dies, UNIFLEX offers a 3-year warranty for the SC 6 and SC 6 S series.



SC 6



SC 6 Ecoline C.2



SC 6 Ecoline





SC 6 Ecoline      SC 6      SC 6 S Ecoline      SC 6 S

Technical Data	SC 6 Ecoline	SC 6	SC 6 S Ecoline	SC 6 S
Crimp force (kN/Ton)	2,000/200	2,000/200	2,800/280	2,800/280
No grease: 20% less friction	✓	✓	✓	✓
Control	Control A	Control A	Control A	Control A
SAE R 15*/4SH 1 piece fitting	2"	2"	2"	2"
4 SH* 2 piece fitting	2"	2"	2"	2"
SAE R 15* 2 piece fitting	1½"	1½"	2"	2"
Industrial	3"	3"	3"	3"
90° Elbows	2"	2"	2"	2"
Crimp range (mm/inch)	102 / 4.02	102 / 4.02	102 / 4.02	102 / 4.02
Opening (mm/inch)	+45 / +1.77	+45 / +1.77	+45 / +1.77	+45 / +1.77
Opening without dies (mm/inch)	147 / 5.78	147 / 5.78	147 / 5.78	147 / 5.78
Master dies length (mm/inch)	110 / 4.33	110 / 4.33	110 / 4.33	110 / 4.33
Type of dies	239 - xx/266 **	239 - xx/266 **	239 - xx/266 **	239 - xx/266 **
Speed (mm/sec)				
Close	4.9	9.7	3.0	6
Crimp	2.3	2.2	1.4	1.4
Open	8.2	16	5.3	13.3
Noise level	69 dBA	67 dBA	69 dBA	67 dBA
Drive	4 kW 3 VAC	4 kW 3 VAC	4 kW 3 VAC	4 kW 3 VAC
Oil	50 l	70 l	50 l	70 l
L x W x H (mm)	700 x 600 x 735	745 x 600 x 1360	700 x 600 x 735	745 x 600 x 1,360
Weight	275 kg	375 kg	315 kg	415 kg
<b>Options</b>				
12 VDC/24 VDC	✓	-	✓	-
1 Phase	✓	✓	✓	✓
Control C.2/IPC	✓	✓	✓	✓

Type of dies		
239-xx-Ø-yy 266		
Ø mm	mm	mm
6.8	65	
9	65	
10	65	
12	65	
14	65	
16	65	
17	65	
19	65	
20	65	
22	65	
24	65	
26	65	
28	80	
30	80	
31	80	
32	80	
34	80	
36	80	
38	80	
39	80	
40	80	
44	80	
47	100	
50	100	
54	100	
57	100	
62	100	110
67		110
71		110
74		110
78		110
84		110
86		110
92		110
94		110

\* According to the fitting.      \*\* Without intermediate dies.  
 Packages page 28 / Accessories and options page 56

## Description



The S 6 series can be used to crimp short 90° elbow fittings with a long drop. This is impossible for other conventional machines.

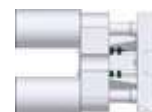

SC = Press tool with Cylinder



Due to their narrow and innovative construction, high level of user friendliness and long service life, the SH 6 series set new standards for quality and cost effectiveness. Their large opening +43 mm ( + 1.69") and light weight 172 kg make it the perfect machine for mobile application up to 2" 4 SP and 3" return line.

The use of long master dies allows you to crimp 90° elbow fittings up to 2" with the tried and tested greaseless slide bearing technology, which reduces maintenance costs and increases the product quality.



SH 6 Ecoline



SH 6 Mobileline



SH 6 Ecoline

SH 6 Mobileline

SH 6 S Ecoline

SH 6 S Mobileline

Technical Data	SH 6 Ecoline	SH 6 Mobileline	SH 6 S Ecoline	SH 6 S Mobileline	Type of dies																																																																																																												
Crimp force (kN/Ton)	2,400/240	2,400/240	2,800/280	2,800/280	 <b>239-xx-Ø-yy 266</b> <table border="1"> <thead> <tr> <th>Ø mm</th> <th>mm</th> <th>mm</th> </tr> </thead> <tbody> <tr><td>6,8</td><td>65</td><td></td></tr> <tr><td>9</td><td>65</td><td></td></tr> <tr><td>10</td><td>65</td><td></td></tr> <tr><td>12</td><td>65</td><td></td></tr> <tr><td>14</td><td>65</td><td></td></tr> <tr><td>16</td><td>65</td><td></td></tr> <tr><td>17</td><td>65</td><td></td></tr> <tr><td>19</td><td>65</td><td></td></tr> <tr><td>20</td><td>65</td><td></td></tr> <tr><td>22</td><td>65</td><td></td></tr> <tr><td>24</td><td>65</td><td></td></tr> <tr><td>26</td><td>65</td><td></td></tr> <tr><td>28</td><td>80</td><td></td></tr> <tr><td>30</td><td>80</td><td></td></tr> <tr><td>31</td><td>80</td><td></td></tr> <tr><td>32</td><td>80</td><td></td></tr> <tr><td>34</td><td>80</td><td></td></tr> <tr><td>36</td><td>80</td><td></td></tr> <tr><td>38</td><td>80</td><td></td></tr> <tr><td>39</td><td>80</td><td></td></tr> <tr><td>40</td><td>80</td><td></td></tr> <tr><td>44</td><td>80</td><td></td></tr> <tr><td>47</td><td>100</td><td></td></tr> <tr><td>50</td><td>100</td><td></td></tr> <tr><td>54</td><td>100</td><td></td></tr> <tr><td>57</td><td>100</td><td></td></tr> <tr><td>62</td><td>100</td><td>110</td></tr> <tr><td>67</td><td></td><td>110</td></tr> <tr><td>71</td><td></td><td>110</td></tr> <tr><td>74</td><td></td><td>110</td></tr> <tr><td>78</td><td></td><td>110</td></tr> <tr><td>84</td><td></td><td>110</td></tr> <tr><td>86</td><td></td><td>110</td></tr> <tr><td>92</td><td></td><td>110</td></tr> <tr><td>94</td><td></td><td>110</td></tr> </tbody> </table>	Ø mm	mm	mm	6,8	65		9	65		10	65		12	65		14	65		16	65		17	65		19	65		20	65		22	65		24	65		26	65		28	80		30	80		31	80		32	80		34	80		36	80		38	80		39	80		40	80		44	80		47	100		50	100		54	100		57	100		62	100	110	67		110	71		110	74		110	78		110	84		110	86		110	92		110	94		110
Ø mm	mm	mm																																																																																																															
6,8	65																																																																																																																
9	65																																																																																																																
10	65																																																																																																																
12	65																																																																																																																
14	65																																																																																																																
16	65																																																																																																																
17	65																																																																																																																
19	65																																																																																																																
20	65																																																																																																																
22	65																																																																																																																
24	65																																																																																																																
26	65																																																																																																																
28	80																																																																																																																
30	80																																																																																																																
31	80																																																																																																																
32	80																																																																																																																
34	80																																																																																																																
36	80																																																																																																																
38	80																																																																																																																
39	80																																																																																																																
40	80																																																																																																																
44	80																																																																																																																
47	100																																																																																																																
50	100																																																																																																																
54	100																																																																																																																
57	100																																																																																																																
62	100	110																																																																																																															
67		110																																																																																																															
71		110																																																																																																															
74		110																																																																																																															
78		110																																																																																																															
84		110																																																																																																															
86		110																																																																																																															
92		110																																																																																																															
94		110																																																																																																															
No grease: 20% less friction	✓	✓	✓	✓																																																																																																													
Control	Control A	Control A	Control A	Control A																																																																																																													
SAE R 15*/4SH 1 piece fitting	2"	2"	2"	2"																																																																																																													
4 SH* 2 piece fitting	2"	2"	2"	2"																																																																																																													
SAE R 15* 2 piece fitting	1½"	1½"	2"	2"																																																																																																													
Industrial	3"	3"	3"	3"																																																																																																													
90° Elbows	2"	2"	2"	2"																																																																																																													
Crimp range (mm/inch)	102 / 4.02	102 / 4.02	102 / 4.02	102 / 4.02																																																																																																													
Opening (mm/inch)	+43 / +1.69	+43 / +1.69	+43 / +1.69	+43 / +1.69																																																																																																													
Opening without dies (mm/inch)	145 / 5.71	145 / 5.71	145 / 5.71	145 / 5.71																																																																																																													
Master dies length (mm/inch)	110 / 4.33	110 / 4.33	110 / 4.33	110 / 4.33																																																																																																													
Type of dies	239 - xx/266 **	239 - xx/266 **	239 - xx/266 **	239 - xx/266 **																																																																																																													
Speed (mm/sec)																																																																																																																	
Close	30/1.8	10/0.5	30/1.8	10/0.5																																																																																																													
Crimp	1.8	0.5	1.8	0.5																																																																																																													
Open	10.6/30	3/30	10.6/30	3/30																																																																																																													
Noise level	69 dBA	69 dBA	69 dBA	69 dBA																																																																																																													
Drive	3 kW 3 VAC	1.8 kW 1 VAC	3 kW 3 VAC	1.8 kW 1 VAC																																																																																																													
Oil	35 l	4 l	35 l	4 l																																																																																																													
L x W x H (mm)	600 x 550 x 750	505 x 430 x 490	709 x 613 x 691	505 x 621 x 573																																																																																																													
Weight	196 kg	172 kg	206 kg	182 kg																																																																																																													
<b>Options</b>																																																																																																																	
12 VDC/24 VDC	-	✓	-	✓																																																																																																													
1 Phase	✓	✓	✓	✓																																																																																																													
Control C.2/IPC	✓	-	✓	-																																																																																																													

\* According to the fitting. \*\* Intermediate dies not required.  
 Packages page 28 / Accessories and options page 56

## Description



The 12 VDC/24 VDC units offer space- and weight-saving application options, e.g. for fitting service trucks.



SH = Hollow piston press tool



Due to their narrow and innovative construction, high level of user friendliness and long service life, the SH 10 and SH 10 XL set new standards for quality and cost effectiveness. Their large opening, + 45 mm (+ 1.77") for SH 10 and +61 mm (+ 2.40") for S 10 XL, fits industrial hoses with large flanges.

The use of long master dies allows you to crimp 90° elbow fittings up to 2" with the tried and tested greaseless slide bearing technology, which reduces maintenance costs and increases the product quality.



SH 10 XL



SH 10 Ecoline



SH 10 C.2



SH 10 Ecoline

SH 10

SH 10 XL Ecoline

SH 10 XL

Technical Data	SH 10 Ecoline	SH 10	SH 10 XL Ecoline	SH 10 XL
Crimp force (kN / Ton)	2,800/280	2,800/280	2,800/280	2,800/280
No grease: 20% less friction	✓	✓	✓	✓
Control	Control A	Control A	Control A	Control A
SAE R 15*/4SH 1 piece fitting	2"	2"	2"	2"
4 SH* 2 piece fitting	2"	2"	2"	2"
SAE R 15* 2 piece fitting	2"	2"	2"	2"
Industrial	4"	4"	4"	4"
90° Elbows	2"	2"	2"	2"
Max. Crimp range (mm/inch)	145 / 5.70	145 / 5.70	145 / 5.70	145 / 5.70
Opening (mm/inch)	+45 / +1.77	+45 / +1.77	+61 / +2.40	+61 / +2.40
Opening without dies (mm/inch)	190 / 7.48	190 / 7.48	200 / 7.87	200 / 7.87
Master dies length (mm/inch)	126 / 4.96	126 / 4.96	126 / 4.96	126 / 4.96
Type of dies	239 - xx/237 L **	239 - xx/237 L **	239-xx-Ø/237 L **	239-xx-Ø/237 L **
Speed (mm/sec)				
Close	4.8	6.1	30/6.0	30/6.0
Crimp	2.3	1.7	1.4	1.4
Open	7.9	10.3	30/17	30/17
Noise level	70 dBA	67 dBA	67 dBA	70 dBA
Drive	4 kW 3 VAC	5.5 kW 3 VAC	4 kW 3 VAC	5.5 kW 3 VAC
Oil	70 l	70 l	70 l	70 l
L x W x H (mm)	700 x 600 x 845	690 x 600 x 1.400	700 x 600 x 845	690 x 600 x 1,400
Weight	372 kg	390 kg	390 kg	430 kg
<b>Options</b>				
Control C.2/IPC	✓	✓	✓	✓
1 Phase	✓	✓	✓	✓
12 VDC/24 VDC	✓	-	✓	-

239-xx-Ø-yy		237 L	
Ø mm	mm	Ø mm	mm
6.8	65	54	118
9	65	57	118
10	65	62	118
12	65	67	118
14	65	71	118
16	65	74	118
17	65	78	118
19	65	84	118
20	65	86	118
22	65	90	118
24	65	96	118
26	65	103	118
28	80	106	126
30	80	111	126
31	80	116	126
32	80	121	126
34	80	126	126
36	80	131	126
38	80	135	126
39	80		
40	80		
44	80		
47	100		
50	100		
54	100		
57	100		
62	100		



SH = Hollow piston press tool

\* According to the fitting. \*\* Intermediate dies not required.  
 Packages page 28 / Accessories and options page 56

## Description



The SH 10 and SH 10 XL-series is fitted with the clean slide bearing technology.



The SH 10 XL offers a large opening travel of up to 61 mm.



ICC – Industrial (hose) Crimp Calculator (with C.2 and IPC controller)

Automatically calculate your crimp diameter directly from your hose and fitting measurement based on compression. Includes the official agreed, tested and approved industrial hose crimp calculator/Interface with fitting and ferrule data from Mario, PT, Campbell and Dixon.



With a 370-ton crimping force, the new SC 12 i is the most powerful workshop crimper for R15 industrial hoses up to 3" and high pressure hoses up to 1". With its large opening and a maximum crimping range of up to 139 mm (5.47"), the SC 12 i also crimps 4" Camlock industrial fittings and even 90° fittings with ease.

The compact design allows direct access from all sides, which is particularly important when crimping short workpieces. Three versions of the SC 12 i are available, with a micrometer, Control C.2 or IPC. Like all UNIFLEX crimpers, the SC 12 i features the legendary UNIFLEX slide bearing technology for maximum cleanliness and consistent operations as well as low maintenance requirements and a full 3-year manufacturer's warranty.



SC 12 i C.2



SC 12 i C.2



SC 12 i C.2



SC 12 i A

SC 12 i C.2

Technical Data	SC 12 i A <b>NEW</b>	SC 12 i C.2 <b>NEW</b>
Crimp force (kN/Ton)	3,700/370	3,700/370
No grease: 20% less friction	✓	✓
Control	Control A	Control C.2
SAE R 15*/4SH 1 piece fitting	3"	3"
4 SH* 2 piece fitting	3"	3"
SAE R 15* 2 piece fitting	3"	3"
Industrial	4"	4"
90° Elbows	2"	2"
Max. Crimp range (mm/inch)	145 / 5.71	145 / 5.71
Opening (mm/inch)	+61 / +2.40	+61 / +2.40
Opening without dies (mm/inch)	206 / 8.11	206 / 8.11
Master dies length (mm/inch)	126 / 4.96	126 / 4.96
Type of dies	239 / 237L	239 / 237L
Speed (mm/sec)		
Close	30/4.9	30/4.9
Crimp	1.4	1.4
Open	30/8.6	30/8.6
Noise level	< 70 dBA	< 70 dBA
Drive	5.5 kW 3 VAC	5.5 kW 3 VAC
Oil	85 L	85 L
L x W x H (mm)	690 x 750 x 1,470	690 x 750 x 1,470
Weight	553 kg	555 kg
<b>Options</b>		
12 VDC/24 VDC	✓	-
1 Phase	✓	-
Control C.2/IPC	✓	✓

Type of dies

239-xx-Ø-yy	
Ø mm	mm
6.8	65
9	65
10	65
12	65
14	65
16	65
17	65
19	65
20	65
22	65
24	65
26	65
28	80
30	80
31	80
32	80
34	80
36	80
38	80
39	80
40	80
44	80
47	100
50	100
54	100
57	100
62	100

Type of dies

237 L	
Ø mm	mm
54	118
57	118
62	118
67	118
71	118
74	118
78	118
84	118
86	118
90	118
96	118
103	118
106	126
111	126
116	126
121	126
126	126
131	126
135	126
137	126



SC = Press tool with Cylinder

\* According to the fitting. \*\* Intermediate dies not required.  
 Packages page 28 / Accessories and options page 56

Description



The micrometer allows you to set crimp dimensions to set. (Control A)



The SC 12 series can be used to crimp short 90° elbow fittings with a long drop. This is impossible for other conventional machines.



ICC – Industrial (hose) Crimp Calculator (with C.2 and IPC controller)  
 Automatically calculate your crimp diameter directly from your hose and fitting measurement based on compression. Includes the official agreed, tested and approved industrial hose crimp calculator/Interface with fitting and ferrule data from Mario, PT, Campbell and Dixon.

## Packages

		QDS 263 B		
SH 2 M Ecoline				Package: Machine + PB Ø 14, 17, 20, 24 + QDS 26X B
SH 2 M H2, SH 2 P, SH 2 A, SH 2 LA				Package: Machine + PB Ø 14, 17, 20, 24, 28, 32, 40 + QDS 26X B
		QDS 239 B	QDC 239.5	
HM 200, SC 3, SH 4				Package: Machine + PB Ø 17, 20, 24, 28, 32, 40, 44, 50 + QDS 239 B + QDC 239.5
SC 4				Package: Machine + PB Ø 17, 20, 24, 28, 32, 40, 47, 54, 62 + QDS 239 B + QDC 239.5
SH 7, SC 6, SH 6, SH 6 S				Package: Machine + PB 17, 20, 24, 28, 32, 40, 44, 50, 57, 71 + 265.239 L + QDS 239 B + QDC 239.5
SH 10 i, SH 10 i XL				Package: Machine + PB Ø 17, 20, 24, 28, 32, 40, 44, 50, 57, 71 + 237.239.2L2 + QDS 239 B + QDC 239.5
SC 12 i				Package: Machine + PB Ø 17, 20, 24, 28, 32, 40, 44, 50, 57, 71 + 237.239.2L2 + QDS 239 B + QDC 239.5

### PUM 0.8/3.2-700 bar...

The mobile high-pressure power unit manages 700 bar: a real magic box!

UNIFLEX mobile hydraulic power packs are popular worldwide due to their high performance, robustness and compact dimensions. With an innovative high-pressure power unit, UNIFLEX now offers a practical accessory, namely an ingeniously simple external power tool: with a standard cordless screwdriver (min. 25 Nm drive torque), manual workshop presses for 1" hoses (4SH/R15) can be driven hydraulically.



### ... with SH 2 Ecoline and cordless screwdriver

Nominal pressure	70 MPa (700 bar)
Adjustable pressure relief valve	up to 700 bar manually adjustable
Drive	All commercially available cordless screwdrivers (min. 25Nm)
Temperature range	10°C to +35°C
Shoulder strap	✓
Oil tank volume	2.5 l
Pressure gauge measuring connection	✓
Delivery rate	3.2 L/min Low pressure up to 5 MPa (50 bar) 0.8 L/min High pressure above 5 MPa (50 bar)
L x W x H (mm)	L x W x H (mm) 245 x 170 x 220
Weight	8.5 kg with oil





# Less than 0.0021€ per crimping operation\*

The slide bearing technology at UNIFLEX is so economical.



## Witnesses:

One of many customer machines from 1993 with over 16 million crimping operations.



## \* That pays off for you!

A change of plain bearings, oil, springs and a revision every 2 years costs, at a life cycle of 23 years, about 14 000 euros. Added at a machine price of 20 000 € you have 34 000 € total costs for 16,000,000 crimping operations.

**That's just 0.0021 € per crimping operation.**

## In comparison

The slide bearing technology takes only 2 minutes per week for service to remove the deposits. For lubricated machines you need 7 minutes to put in the lubricant.

## Maximum productivity! Low operating costs!

Bearing machines hardly lose production time at weekly service. We are talking about 200 hours with a lifetime of 10 years.

## Slide bearing technology is more environmentally friendly than lubricated machines

Our slide bearing technology reduces crimp force loss up to 20% through less friction between the moving parts of the machine. This leads to less energy consumption up to 20%.

## Dirt-free slide bearing technology

- The process and repeat accuracy is stabilized since no grease-dirt-mix penetrates into seals and dies.
- Loose Oxid scale does not settle in grease— as a result no tool wear.
- A grease-free hose line is ideal for use in the food and pharmaceutical industries.
- No dirty hands when changing the dies.



Machine still in use after 20 years

## The Best Return on Investment

Our technology offers the Best Return on Investment! Not only compared to lubricated crimpers, but also with other investments.

For example, consider the automotive sector. How often do you go to the workshop and how much do you pay for a kilometer? In the automotive industry one speaks of 0.70 € / km!

## Slide bearings:

So low under cost, that a better and preventive service on the machine is possible.

## Lubricant-free means:

Simple change of the bearing plates and the machine functions again almost like new.

## When should the slide bearings be exchanged?

It is difficult to say how often the slide bearings should be exchanged, since this depends on many factors. The number of crimping operations, the pressure applied as well as the type and amount of material chips of the individual hoses and fixings.

## Our recommendation:

- For production = 1 shift = 1x per year
- For workshop = every 3 to 5 years



Sliding bearing in condition after ca. 900.000 crimping operations

## How to extend the service life of a slide bearing?

You can extend the service life time of a slide bearing by regularly vacuuming away the dry chips, e.g., by means of a workshop vacuum, instead of blowing them off with compressed air.

## When is a complete technological obsolescence recommended?

For production workshops, we recommend a technological obsolescence every 3 years, for repair shops 5 - 10 years are sufficient.

## Thank you for reading our article.

If you have any questions regarding slide bearing prices, please contact our sales team: [sales@uniflex.de](mailto:sales@uniflex.de)

For questions regarding a complete overhaul our service is at your disposal: [service@uniflex.de](mailto:service@uniflex.de)

In case of a complete overhaul, please send us the serial no. and pictures or videos via

**WhatsApp: +49 152 03540155**

UNIFLEX-Hydraulik GmbH  
Robert-Bosch-Strasse 50-52  
61184 Karben / Germany



# The best Return on Investment



## Profitability, sustainability and climate protection with a different approach:

It's logical: Whoever wants to work economically and wishes to save money takes a look at the expenses. But, whoever wishes to be smarter when saving money not only looks at the acquisition price, but also the operating costs and the service life of their investments.

The success story of UNIFLEX started with the invention of the slide bearing technology 50 years ago – and now, another chapter is being opened: the next 50 years of UNIFLEX. It is true, the slide bearing technology makes UNIFLEX machines a little more expensive than comparable crimpers with costly grease lubrication, but UNIFLEX machines are much more **sustainable because they last longer and are cost-favourable when you consider the energy consumption and maintenance requirements; moreover, they ensure a better CO<sub>2</sub> balance.**

The slide bearing technology reduces the loss of crimp force by up to 20% – due to the reduced friction between the moving parts of the machine. This lowers energy consumption by up to 20%. Another advantage is the cleanliness during the operations for the user, the workpiece and the machine.

## Sustainability pays off

Hydraulic crimpers with slide bearing technology from UNIFLEX are offering a Return on Investment that is second to none.

- The cost of exchanging slide bearings, oil, springs as well as a refurbish every 2 years for a life cycle of 23 years amounts to approximately € 14,000. Added to a machine price of € 20,000, this results in total costs of € 34,000 for 16,000,000 crimping processes.
- Furthermore, the slide bearing technology requires only 2 minutes of service per week to remove deposits. Lubricated machines require about 7 minutes in addition to the cleaning process to regrease with the lubricant.

**As a result, the cost per crimping process decreases to an incredible € 0.0021!**



**That's what climate protection looks like: A machine still in operation after more than 25 years and more than 16,000,000 crimping processes.**

